

# Spectra ST<sup>1</sup>

## Universal Composite Restorative

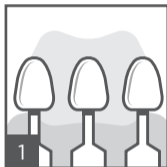

### Shade selection

Use the VITA<sup>®2</sup> Shade Guide and i-shade label or the Spectra ST shade fingers.

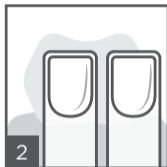

### Conditioning and/or bonding

Apply acid conditioner followed by adhesive or self-etching adhesive. Consult directions for use.

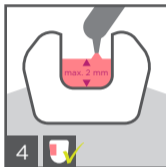

### Placement of restorative

Place increments of a maximum of 2 mm.



### Light-curing

Light-cure each increment according to provided curing chart.

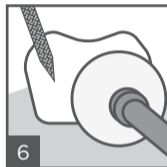

### Finishing and polishing

Shape and contour, finish and polish (e.g. with Enhance<sup>®</sup> Finishing System and Enhance<sup>®</sup> PoGo<sup>®</sup> Polishing System).

<sup>1</sup> Depending on market location, Spectra ST is available as either TPH Spectra<sup>®</sup> ST, Ceram.x Spectra<sup>™</sup> ST, or Neo Spectra<sup>™</sup> ST.

<sup>2</sup> VITA<sup>®</sup> is not a registered trademark of Dentsply Sirona, Inc.



Caution, consult directions for use

# Spectra ST<sup>1</sup>

## Universal Composite Restorative





### Shades available

Spectra ST

Universal CLOUD shades:  
A1, A2, A3, A3.5, A4

Additional shade:  
BW (Bleach White)

### Curing Chart

| Shade  | <br>mW/cm <sup>2</sup> | <br>sec | <br>mm |
|--------|---|--|---|
| A1- A4 | ≥ 550   | 20   | 2   |
| BW     | ≥ 800   | 10   |   |

### i-shade label

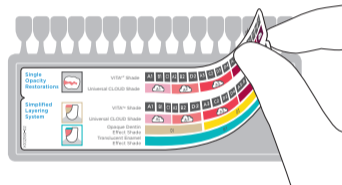

Stick i-shade label to VITA<sup>®2</sup> Shade Guide

### Shade Guide

|  |                          |    |    |    |    |    |    |    |    |    |    |      |    |    |    |    |    |   |                      |
|--|--------------------------|----|----|----|----|----|----|----|----|----|----|------|----|----|----|----|----|---|----------------------|
|  | VITA <sup>®2</sup> Shade | A1 | B1 | C1 | A2 | B2 | D2 | A3 | C2 | D3 | D4 | A3.5 | B3 | B4 | C3 | A4 | C4 | + | BW<br>(Bleach White) |
|  | Universal CLOUD Shade    | A1 |    |    | A2 |    |    | A3 |    |    |    | A3.5 |    |    | A4 |    |    |   |                      |